

order number	lens name
0703-005-000-40	Apo-Rodagon-D 1x 4/75

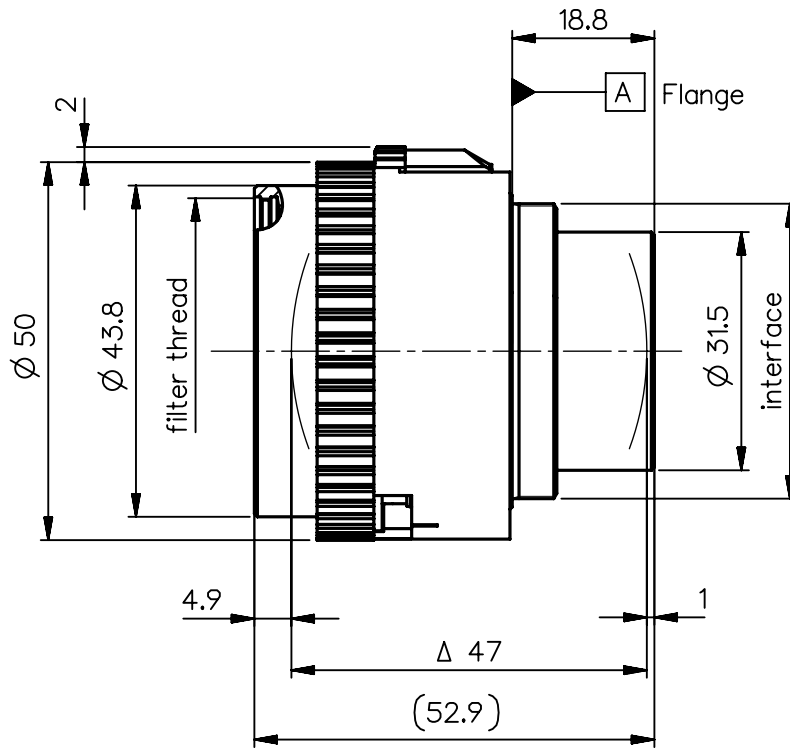

<b>Specification</b>		ON	8501-9002
image circle max. (mm)	82	working distance (mm)	100 - 130
focal length f' (mm)	74.9	interface	M39 x1/26" (Leica)
magnification β' [range]	-1 [-1.2 ... -0.8]	filter thread	M40.5 x0.5
spectral range λ (nm)	400 - 750	weight (g)	130

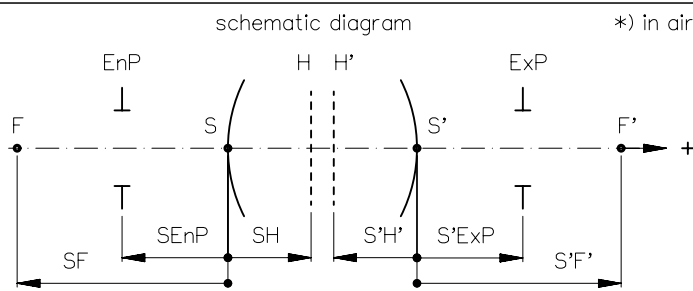

design includes CCD cover glass:		no		
SF (mm)	-44.2	f-stop	Ø EnP	Ø Exp
S'F' (mm) *	44.2	4	18.7	18.7
HH' (mm) *	-14.35	5.6	13.4	13.4
SH (mm)	30.7	8	9.4	9.4
S'H' (mm) *	-30.7	11	6.8	6.8
SEnP (mm)	30.7	16	4.7	4.7
S'Exp (mm) *	-30.7	22	3.4	3.4

NX PROTECTIVE NOTE "DIN ISO 16016" TO BE OBSERVED	EU-D		AL-T1A		US-D		US-ML		not export controlled				
	REV		DATE		APPROVED		PDM Status		Freigabe				
	a		05.08.14		Schiffe		SCALE		1:1				
	b		16.06.16		Bo II		MATERIAL						
BASIC TOLERANCING PRINCIPLE						TITLE							
						Apo-Rodagon-D 1x 4/75							
FIRST						DATE		NAME					
ISSUE						05.08.14		Schifferer					
CHKD						05.08.14		Stauder					
DIN A 4 ALL DIMENSIONS ARE IN MM AND INCLUDE SURFACE TREATMENT								DRAWING NO.				SHEET 1	
								0703-005-100-00-0001b				OF 1	
						REPLACES							

# Apo-Rodagon-D\_1x\_75

MTF at ratio 1x f/ 4

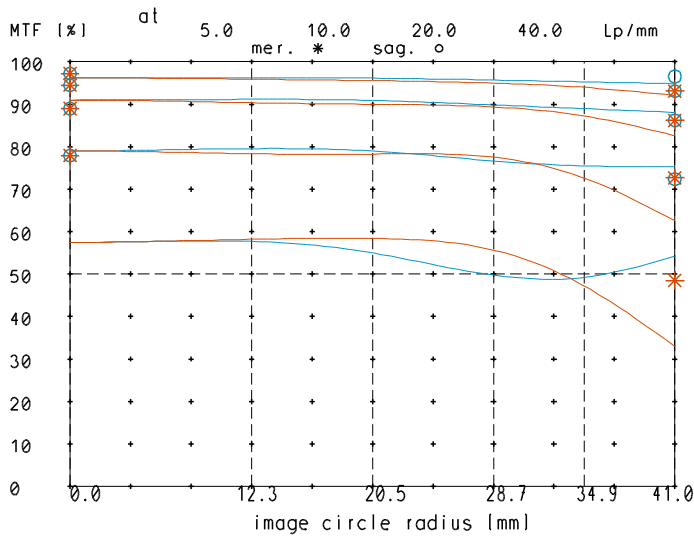

relative light fall-off at ratio 1x

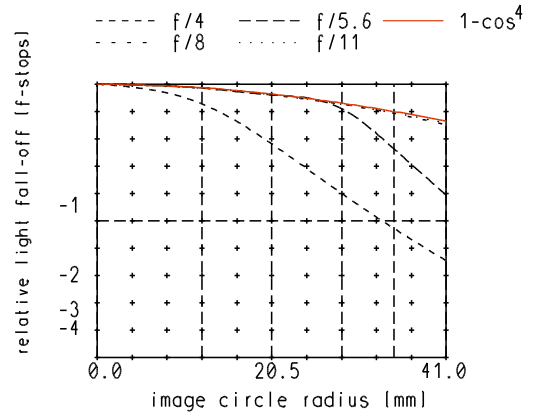

MTF at ratio 1x f/ 8

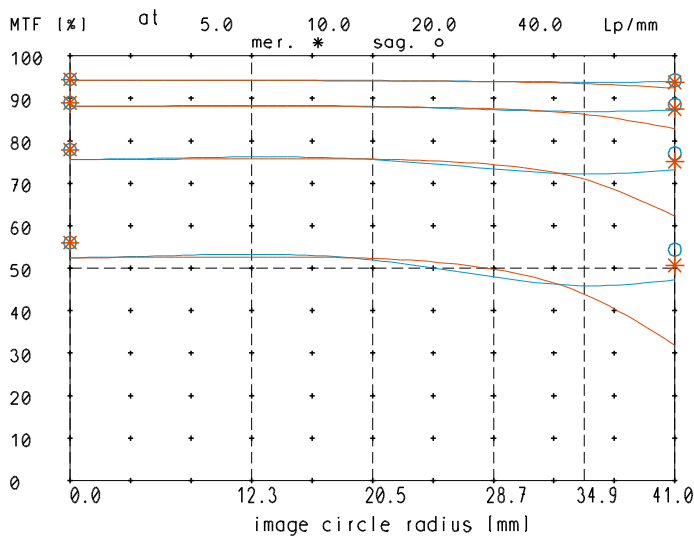

Distortion at ratio 0.8x to 1.2x

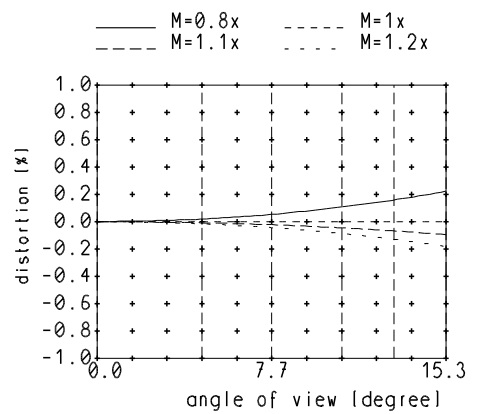

— sagittal. o Diffraction limited value  
 — meridional \* Diffraction limited value

Longitudinal color aberration at ratio 1x

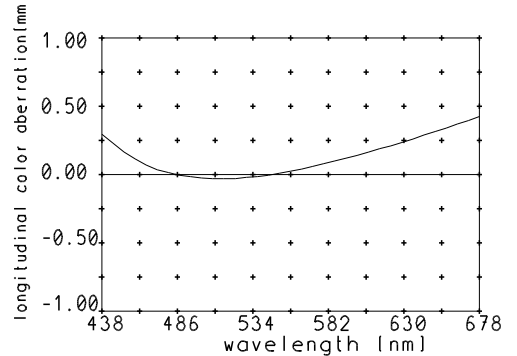

Named frequencies (line pairs/mm) in modular transfer function (MTF) as well as diagrams of relative light fall-off, distortion and longitudinal color aberration refer to film plane.