

order number	lens name
0801-397-000-40	Rogonar-S 2.8/50

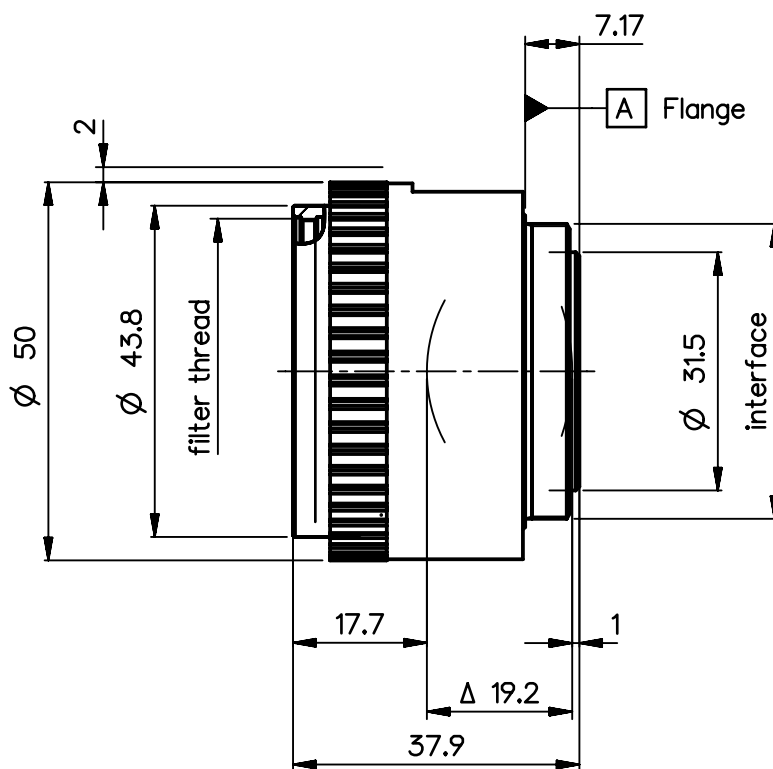

Specification		ON	7706-9001
image circle max. (mm)	44.0	working distance (mm)	153 - 707
focal length f' (mm) *	51.1	interface	M39 x1/26" (Leica)
magnification β' [range]	-0.1 [-0.4 ... -0.075]	filter thread	M40.5 x0.5
spectral range λ (nm)	400 - 750	weight (g)	80

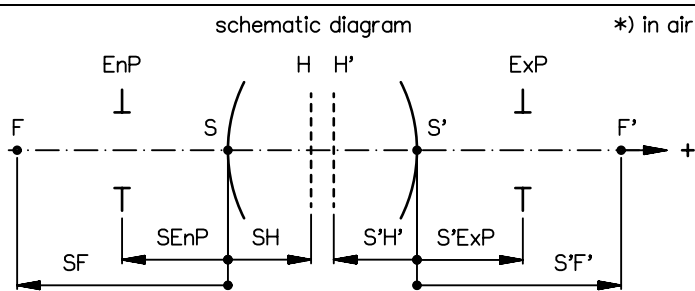

design includes CCD cover glass:		no	
SF (mm)	-43.1	f-stop	
S'F' (mm) *	41.2	Ø EnP	17.6
HH' (mm) *	1.2	Ø Exp	18.3
SH (mm)	8.1		
S'H' (mm) *	-9.9		
S'EnP (mm)	6.1		
S'Exp (mm) *	-12.0		

PROTECTIVE NOTE "DIN ISO 16016" TO BE OBSERVED	EU-D	AL-T1A	US-D	US-ML	not export controlled
	REV	ECC	DATE	APPROVED	PDM Status Freigabe
	a	Neuausg			-
	b	11-358	13.07.11	Kuehne	SCALE 1:1
	c	12-0185	27.03.12	Schuber	MATERIAL
d	14-0184	06.03.14	Schiffle	BASIC TOLERANCING PRINCIPLE	TITLE
e	14-0184	12.08.14	Schiffle		Rogonar-S 2.8/50
			FIRST ISSUE	DATE	NAME
			CHKD	04.07.08	Auer
				04.07.08	Schaeffler
DIN A 4	ALL DIMENSIONS ARE IN MM AND INCLUDE SURFACE TREATMENT				
				DRAWING NO.	SHEET 1
				0801-397-100-40-0001e	OF 1
				REPLACES 0801-364-100-20	

Rogonar-S_2.8/50

MTF at ratio -0.1 f/ 2.8

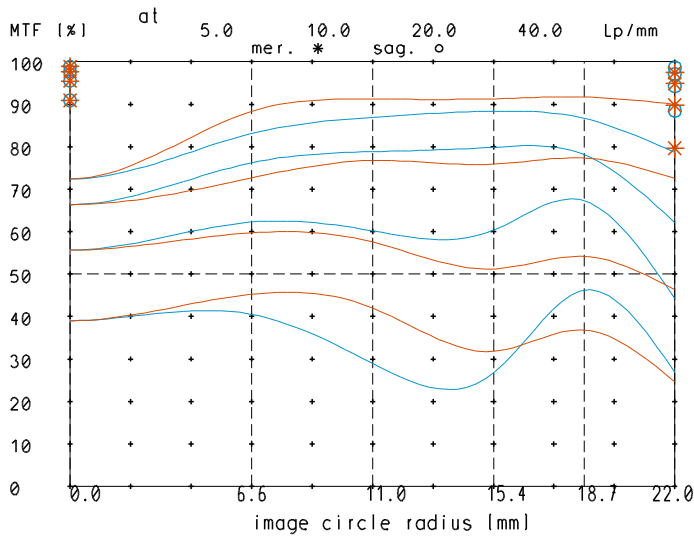

relative light fall-off at ratio -0.1

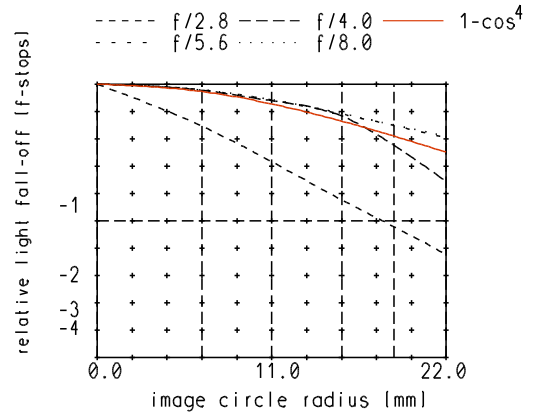

MTF at ratio -0.1 f/ 4.0

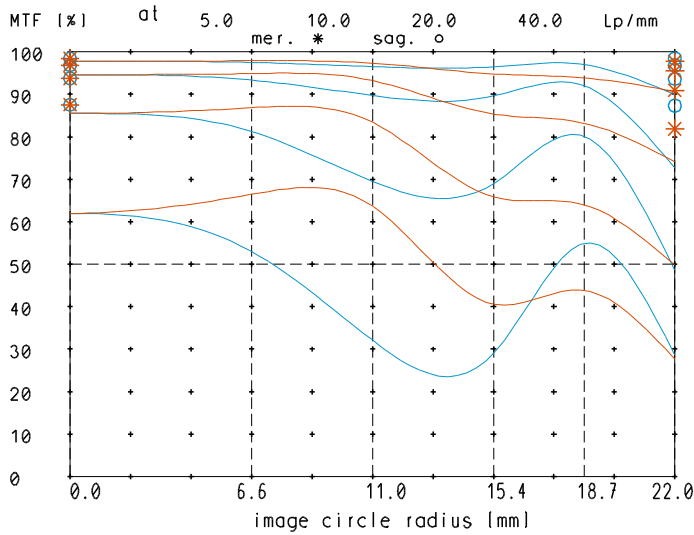

Distortion at ratio -0.05 to -0.4

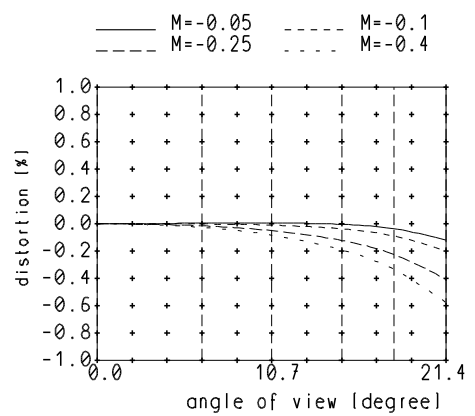

— sagittal. ○ Diffraction limited value
— meridional * Diffraction limited value

Longitudinal color aberration at ratio -0.1

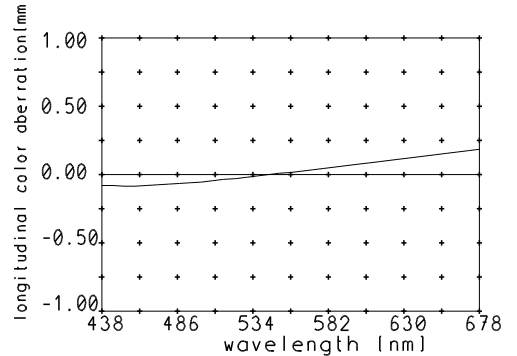

Named frequencies (line pairs/mm) in modular transfer function (MTF) as well as diagrams of relative light fall-off, distortion and longitudinal color aberration refer to film plane.