



Amphenol
FCI

© 2016 AFCl

1

2 3

4

5

6

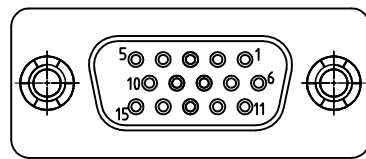
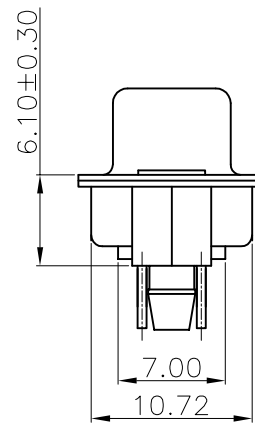
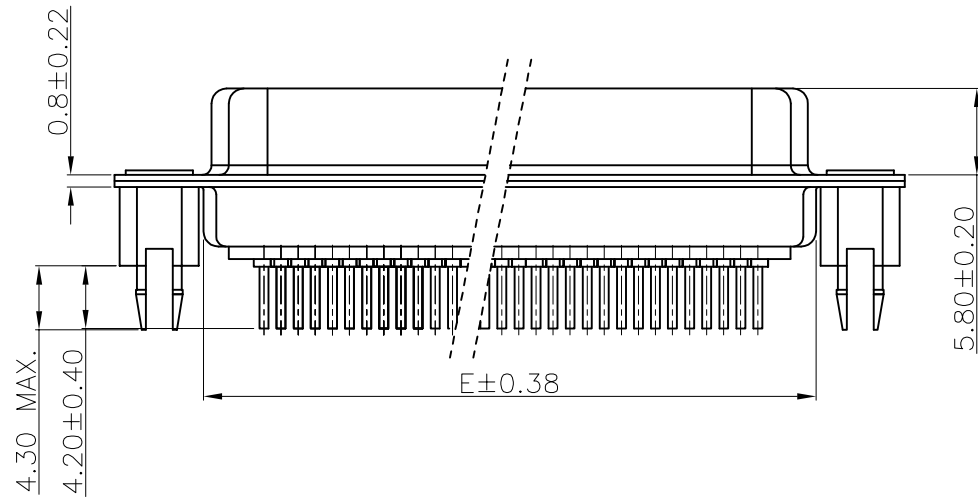
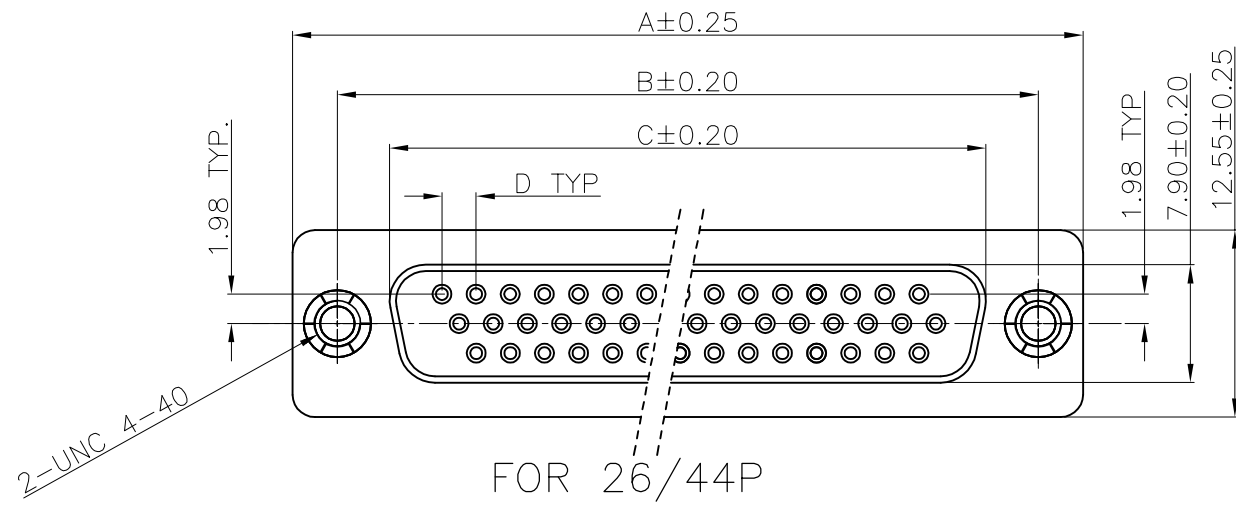

FOR 15P

NOTES:

1. CHARACTERISTICS:

- RATED VOLTAGE: 250V
- RATED CURRENT: 2.5AMP
- CONTACT RESISTANCE: 25mohms MAX. INITIAL,
40mohms MAX. AFTER.
- INSULATION RESISTANCE: 5000Mohms MIN. at 500V DC
- DIELECTRIC STRENGTH: 750VRMS
- OPERATING TEMPERATURE RANGE: -55° C~105° C
- INSERTION/EXTRACTION FORCE PER CONTACT: 5N Max./0.2N Min.
- MATING/UNMATING CYCLES: 200MATINGS MIN FOR GOLD-FLASH
500MATINGS MIN FOR 30u" GOLD.

2. MATERIAL:

- INSULATORS: THERMOPLASTIC G.F(UL94V-0) BLACK
- CONTACTS: COPPER ALLOY, GOLD(G/F or 30u") TOP OVER CONTACT AREA, 100u" Min MATTE TIN TOP OVER SOLDER AREA, 50u" Min NICKEL UNDER PLATE.
- SHELL: CARBON STEEL, 100u" Min NICKEL TOP OVER, 50u" Min COPPER UNDER PLATE.
- HARPOON: COPPER ALLOY, 100u" Min MATTE TIN PLATED.

3. Process conditions for soldering

For H type:

The housing will withstand exposure to 260° C peak temperature for 10 seconds maximum in a wave soldering application

For S Type:

The housing will withstand exposure to 205° C peak temperature for 5 seconds maximum in a wave soldering application

4. PART NUMBER DESCRIPTION:

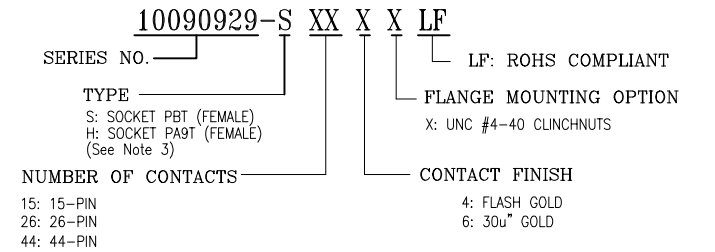

POS.	PART NO.	THREAD TYPE
15	10090929-*15*XLF	UNC #4-40
26	10090929-*26*XLF	UNC #4-40
44	10090929-*44*XLF	UNC #4-40

POS.	A	B	C	D	E
15	30.81	24.99	16.33	2.29	19.10
26	39.24	33.32	24.66	2.29	27.75
44	53.04	47.04	38.38	2.29	41.30

mat'l. code		surface		tolerance		projection		product family	
-		ISO 1302 ✓		ISO 406 ISO 1101				D-SUB	
ltr		ecn no		dr		date		title	
A		T09-1156		JH		12/10/09		H/D D-SUB FEMALE STRAIGHT	
B		T10-0164		JH		10/19/10			
C		ELX-I-15500		AB		2013/08/21			
D		ELX-I-18426		AB		2014/07/29		dwg no	
E		ELX-I-20972		AB		2015/05/30		sheet 1 of 3	
F		ELX-I-24092		MP		2016/05/13		size	
G		ELX-I-34650		GM		2019/08/22		A3	
sheet		revision		G		G		type	
index		sheet		1		2		Product Customer Drawing	



Amphenol
FCI

© 2016 AFCl

1

2 3

4

5

6

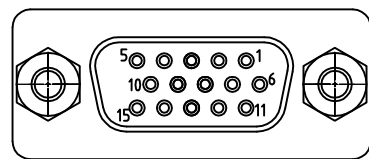
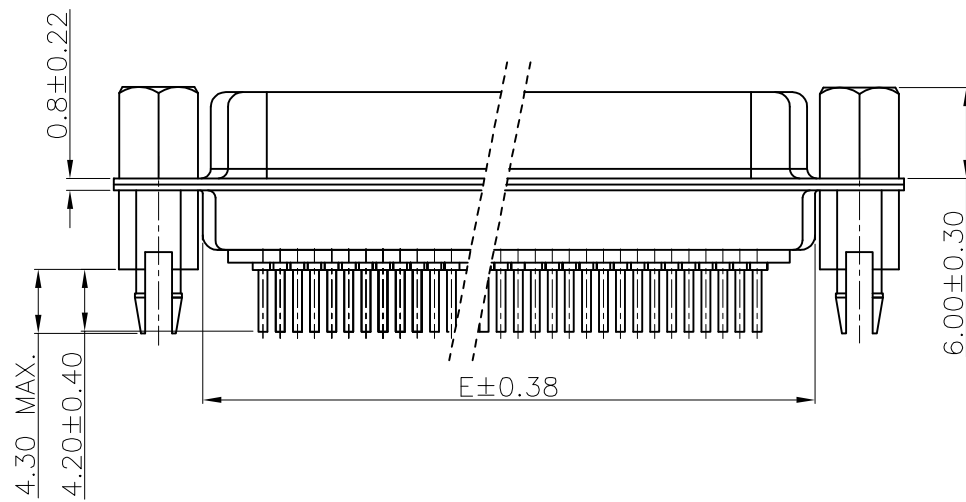
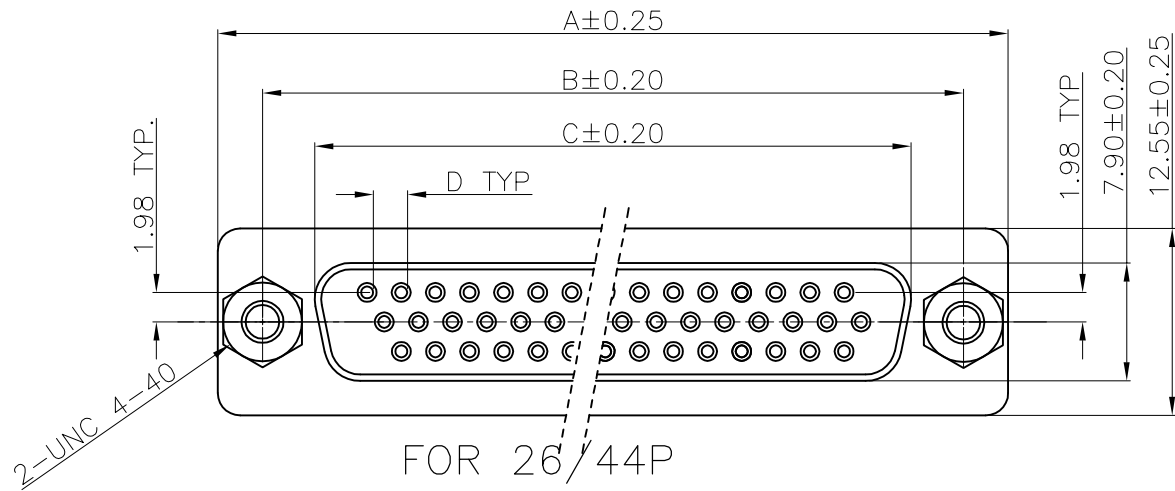

FOR 15P

REMARK:

1. CHARACTERISTICS:

RATED VOLTAGE: 250V
 RATED CURRENT: 2.5AMP
 CONTACT RESISTANCE: 25mohms MAX. INITIAL,
 40mohms MAX. AFTER.
 INSULATION RESISTANCE: 5000Mohms MIN. at 500V DC
 DIELECTRIC STRENGTH: 750VRMS
 OPERATING TEMPERATURE RANGE: -55° C~105° C
 INSERTION/EXTRACTION FORCE PER CONTACT: 5N Max./0.2N Min.
 MATING/UNMATING CYCLES: 200MATINGS MIN FOR GOLD-FLASH
 500MATINGS MIN FOR 30u" GOLD.

2. MATERIAL:

INSULATORS: THERMOPLASTIC G.F(UL94V-0) BLACK
 CONTACTS: COPPER ALLOY, GOLD(G/F or 30U") TOP OVER CONTACT
 AREA, 100u" Min MATTE TIN TOP OVER SOLDER AREA,
 50u" Min NICKEL UNDER PLATE.
 SHELL: CARBON STEEL, 100u" Min NICKEL TOP OVER,
 50u" Min COPPER UNDER PLATE.
 HARPOON: COPPER ALLOY, 100u" Min MATTE TIN PLATED.
 NUT: COPPER ALLOY, 50u" Min NICKEL PLATED.

3. Process conditions for soldering

For H type: The housing will withstand exposure to 260° C peak
 temperature for 10 seconds maximum in a wave soldering application
 For S Type: The housing will withstand exposure to 205° C peak
 temperature for 5 seconds maximum in a wave soldering application

5. PART NUMBER DESCRIPTION:

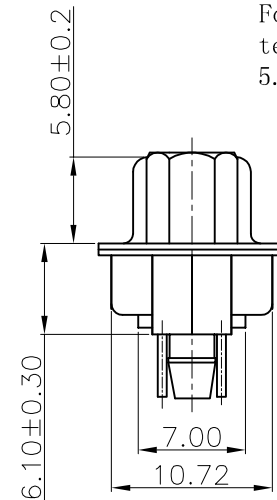

10090929-S XX X V LF
 SERIES NO. _____
 TYPE _____
 S: SOCKET (FEMALE)
 H: SOCKET PA9T (FEMALE)
 (See Note 3)
 NUMBER OF CONTACTS _____
 15: 15-PIN
 26: 26-PIN
 44: 44-PIN
 LF: ROHS COMPLIANT
 FLANGE MOUNTING OPTION
 V: UNC #4-40 SCREWLOCKS
 CONTACT FINISH
 4: FLASH GOLD
 6: 30u" GOLD

POS.	A	B	C	D	E
15	30.81	24.99	16.33	2.29	19.10
26	39.24	33.32	24.66	2.29	27.75
44	53.04	47.04	38.38	2.29	41.30

mat'l. code		surface		tolerance		projection		product family	
-		ISO 1302 ✓		ISO 406 ISO 1101				D-SUB	
ltr	ecn no	dr	date	tolerances unless otherwise specified				title	
G				angles	linear	MM		H/D D-SUB FEMALE STRAIGHT	
				0°±2'		scale 2:1			
		dr	JASON HSU	12/10/09				dwg no	
		enr	MITHUN PAUL	2016/04/27				sheet 2 of 3	
		chr	GREGAR MATHEW	2019/08/22				size	
		appd	SANOJ P K	2019/08/22				A3	
sheet index		revision sheet						type	
								Product Customer Drawing	



© 2016 AFCl

Amphenol
FCI

1

2

3

4

5

6

A

B

C

D

A

B

C

D

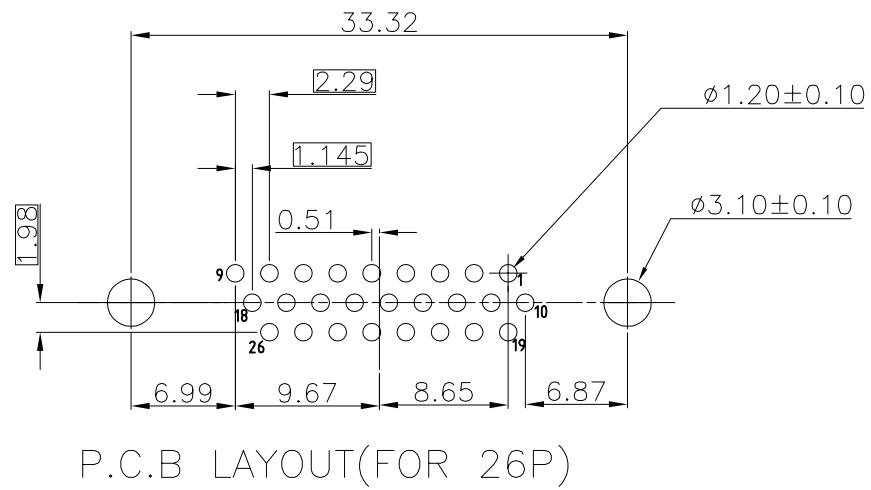
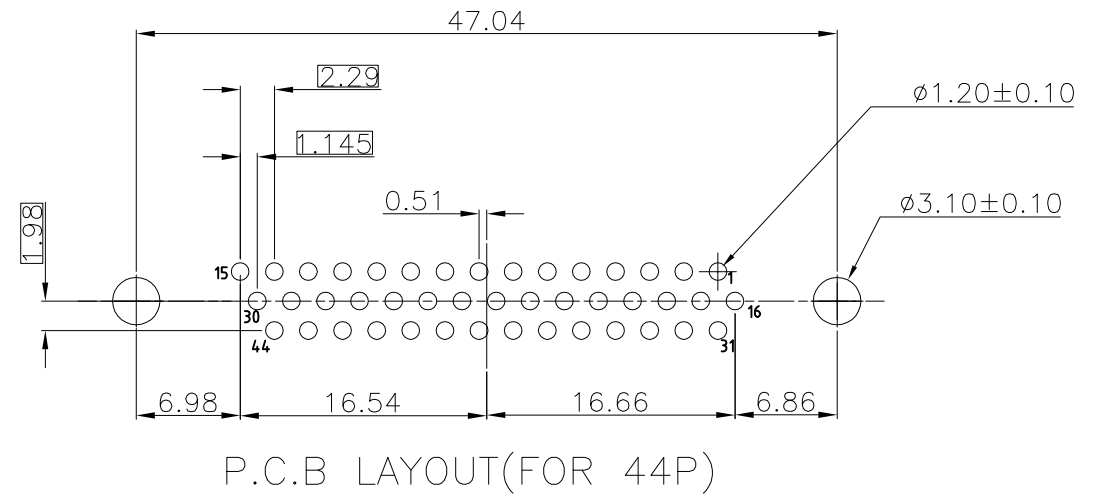
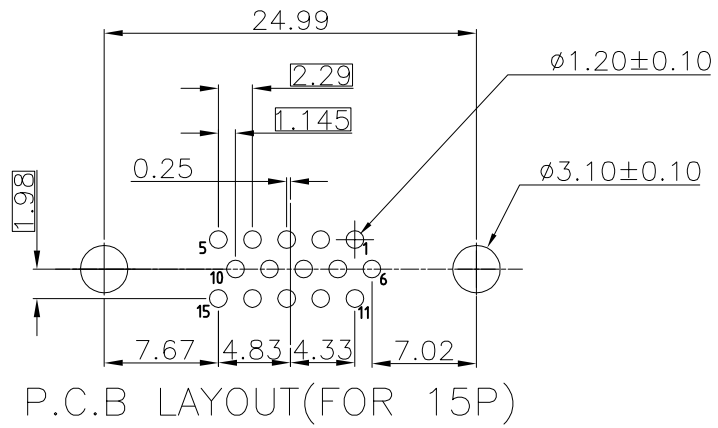

mat'l. code		-		surface		ISO 1302 <input checked="" type="checkbox"/> ISO 406 <input type="checkbox"/> ISO 1101 <input type="checkbox"/>		tolerance		projection		product family	
ltr		ecn no		dr		date		tolerances unless otherwise specified				D-SUB	
G								angles		MM		title	
								linear		scale 2:1		H/D D-SUB FEMALE STRAIGHT	
								0°±2°				dwg no	
												sheet 3 of 3	
												size	
												A3	
												type	
												Product Customer Drawing	
sheet index		revision sheet											