

Part Number & Date Code Printing

LF FOR LEAD FREE

SHELL	A±0.38	B±0.12	C±0.10	D±0.25	G±0.25	PART NUMBER
09	30.81	24.99	16.96	16.79	5.90	D09P13B*PA00**
15	39.14	33.32	25.18	25.12	5.90	D15P13B*PA00**
25	53.03	47.04	39.12	38.84	5.70	D25P13B*PA00**
37	69.32	63.50	55.68	55.30	5.70	D37P13B*PA00**

Plating: 4 --> flash AU  
Plating: 6 --> 0.76» AU

PC card drilling dimensions(after plating)  
(thickness 1.60±0.20mm)

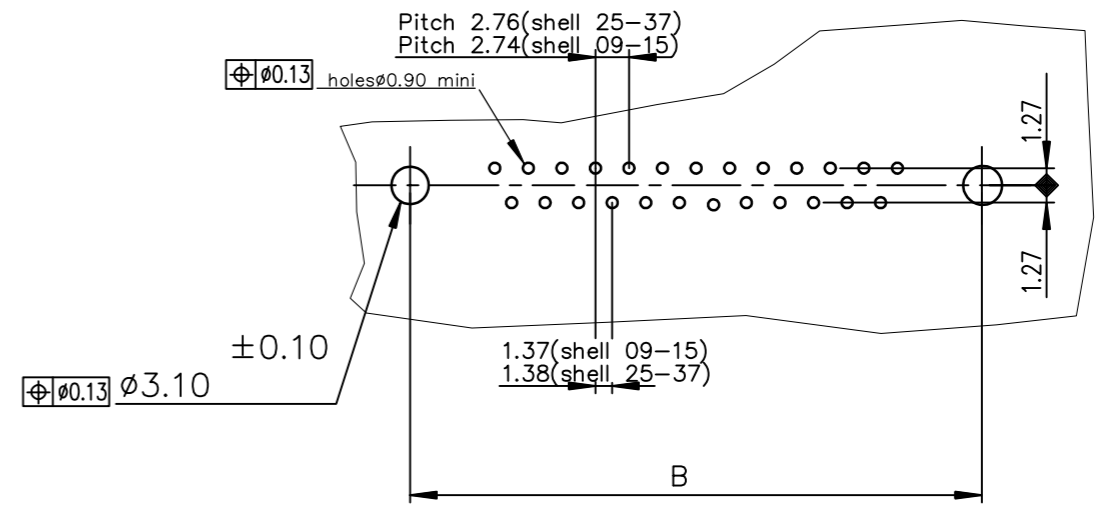

FOR ROHS DETAILS REFER DWG.NO: C01-8646-0000

mat'l. code		surface		tolerance		projection		product family	
SEE NOTES		ISO 1302		ISO 406 ISO 1101		mm		D-SUB	
ltr	ecn no	dr	date	tolerances unless otherwise specified		mm		title	
G	ELX-I-39288	GM	11-12-2020	angles	linear	mm		DELTA-D RIGHT ANGLE SOECKET CONNECTOR WITHOUT ACCESSORY	
				0°±1'		scale NTS		dwg no	
				dr	GREGAR M	11-12-2020	Amphenol FCI	sheet 1 of 1 size	
				enr	GREGAR M	11-12-2020		C01-8646-0162 A3	
				chr	SREERAJ K R	11-12-2020		type Product Customer Drawing	
				appd	SANOJ P K	11-12-2020			
sheet index	revision	G							
	sheet	1							